

Fire Doors around Campus and Their Importance

1 What Do Fire Doors Do?

Fire doors create a barrier from fire and toxic smoke and prevent it from travelling around a building. This keeps damage to a small area, allowing for evacuation, rescue areas, and safe access for emergency services.

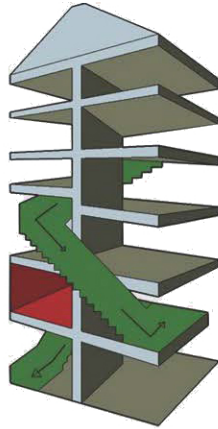

2 Where Will I See Fire Doors In My Building?

You will find fire doors located in stairwells, lining hallways, corridors, or near elevator shafts. You will also see them protecting areas where there's a risk of combustion, such as trash storage areas, maintenance rooms, electrical rooms, and laundry rooms.



3 How Do I Know It's A Fire Door?

Fire doors in common areas (hallways, stairwells, and service rooms) may have a fire door sign on them, but not always. You can look for other components that tell you that the door is a fire-rated door, as indicated in the photo.

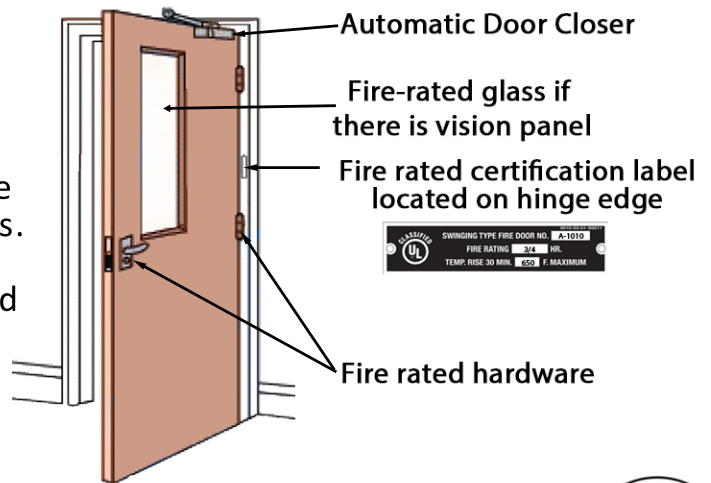

4 What About Door Closers?

All fire doors in common areas of the building (hallways and stairwells) must have appropriate fire rated door closers installed and work properly with correct opening and closing forces.



5 Can I Prop Open A Fire Door With A Wedge Or Other Item?

You cannot prop open a fire door with a wedge or misc item. It is against the fire code to prop open a fire door. Only magnetic door holders tied to the building fire alarm system are allowed to be installed and used to keep fire doors open. These holders will automatically close the fire door if the building's fire alarm is activated. Magnetic holders cannot be easily installed, they require a permit.



6 Who Do I Report Issues To?

Report fire door physical issues to Physical Plant (616-395-7835). For fire door questions/concerns please contact Occupational Health & Fire Safety Office (616-395-7999).



****If a fire door is observed incorrectly propped open, the wedge or item may be removed and a sticky note from Fire Safety will remind users to keep the fire door closed.**